

SURVEY-STRATA PLAN

67899

SHEET 1 OF 1 SHEETS

PLAN OF
LOT 242 ON DP 402525

CERTIFICATE OF TITLE
VOL 2868 FOL 946

LOCAL GOVERNMENT
CITY OF KWINANA

INDEX PLAN
SEE SMART PLAN

FIELD BOOK
130264
(SAM 5008)
SCALE AS SHOWN

NAME OF SCHEME
70 MORNINGTON CRESCENT
WANDI

ADDRESS OF PARCEL
70 MORNINGTON CRESCENT
WANDI, WA 6167

MANAGEMENT STATEMENT YES ~~NO~~

LODGED	CERTIFIED CORRECT
DATE	COR. FILE
IN ORDER FOR DEALINGS	
FEE PAID	SUBJECT TO
ASSESS No.	
	FOR REGISTRAR OF TITLES
	DATE

REGISTERED
APPLICATION
DATE REGISTRAR OF TITLES SEAL

WESTERN AUSTRALIAN PLANNING COMMISSION
W.A.P.C. REF: 1571-13
Certificate of Approval of W.A.P.C. under Section 25B(2) of
Strata Titles Act 1985

Delegated under S.16 P&D 2005 DATE



Western Australian Land Information Authority

VER	AMENDMENT	AUTHORISED BY	DATE

LIMITED IN DEPTH TO 60.96 METRES

INTERESTS AND NOTIFICATIONS

SUBJECT	PURPOSE	STATUTORY REFERENCE	ORIGIN	LAND BURDENED	BENEFIT TO	COMMENTS
	NOTIFICATION	SEC 70A OF THE TLA	DOC M924513	ALL LOTS	MAIN ROADS W.A.	CITY OF KWINANA (FIRE MANAGEMENT PLAN) SEE DP 76538
	COVENANT	SEC 150 OF THE P & D ACT	DP 76538	ALL LOTS		
(P)	EASEMENT (TRANSMISSION OF ELECTRICITY BY UNDERGROUND CABLE)	SEC 136C OF THE TLA	THIS PLAN	LOT 1	LOTS 2-7	
	NOTIFICATION	SEC 70A OF THE TLA	DOC	LOTS 1, 6 & 7		CITY OF KWINANA (TRANSPORT NOISE)

COMMON PROPERTY LOT CP8 IS KNOWN AS CANIA PLACE FOR PROPERTY STREET ADDRESS PURPOSES ONLY AND IS NOT A PUBLIC ROAD

HC - Hilti nail in Concrete
SHN - Spring Head Nail & plate

SCALE 1:500 AT A3 SIZE

SURVEYORS CERTIFICATE - Reg 54
DAVID JAMES GIBB
I,
hereby certify that this plan is accurate and is a correct representation of the -
(a) *survey; and/or
(b) *calculations from measurements recorded in the field records,
(*delete if inapplicable)
undertaken for the purposes of this plan and that it complies with the relevant written law(s) in relation to which it is lodged.
.....
LICENSED SURVEYOR DATE

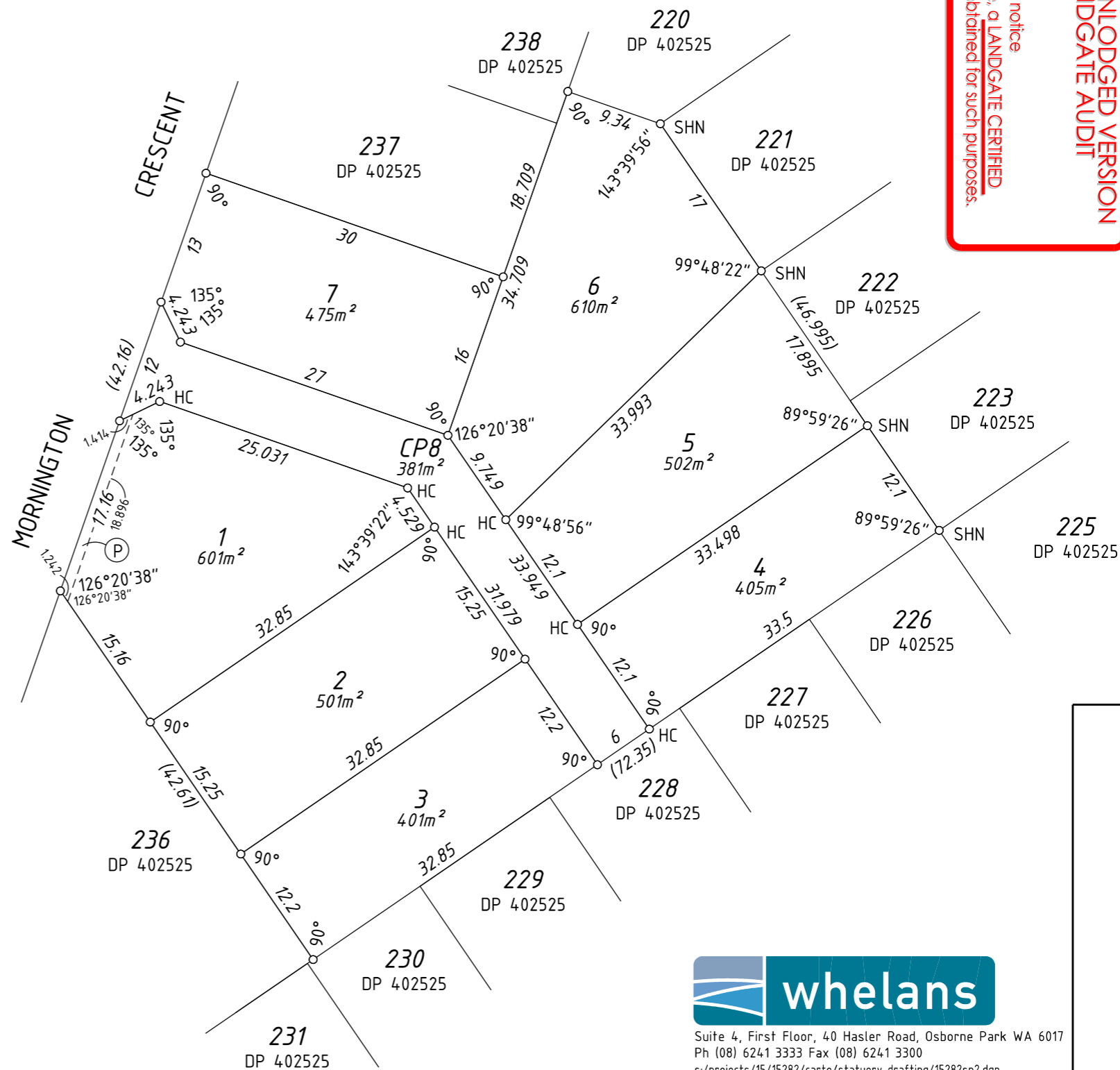

PRELIMINARY ONLY UNLODGED VERSION
 SUBJECT TO LANDGATE AUDIT
 This plan is
 -Current as at 16.04.2015
 -Subject to change without notice
 -Not intended for design use, a LANDGATE CERTIFIED
 -CORRECT copy should be obtained for such purposes.



Suite 4, First Floor, 40 Hasler Road, Osborne Park WA 6017
Ph (08) 6241 3333 Fax (08) 6241 3300
s:/projects/15/15282/carto/statuory draffing/15282sp2.dgn
FP-15282-010-VER 1.0